

Sunday January 21 , 1973

Leta and Lary Bahn and I Billie J. Lewis made a trip ot annapolis Mo. ~~xx~~ to see Macy Slusher who is a Daughter of Uncle Bob Lewis (Fred Lewis Bro) who is approxiamtely 77 years old che~~x~~cking on the lewis family. She took us th a farm that you go west out of annapolis across the railroad track and also big creek and then turn right up and across a small creek called brushey.

There in a old log house <sup>Believed to have been Built by Wm Lewis</sup> we found some people by the name of ~~pa~~ Griggs that had a abstract that told us that our grand father William Lewis and also his father George LEWIS had owned this farm. Also the names of Grand Pa lewis's brothers and sisters which is fournd elsewhere in these files.

We Also fisited a Mrs Perry Sutton who lives south of annapolis that claimed to be the Granddaughter of a Mrs. Hepsi Lewis Ruble who was grandpa lewis's sister. She also told us of a Isom Lewis who lives near by who is also related to us but not known how.

We also visited the lewis Cemenetary which is south of annapolis behind a little church. <sup>before you get to Lead mine</sup> Here Macy told us was Buried Uncle Marion Lewis and his family inside the concrete enclosure but there is no markers. Also Buried in this cemenetry is Mrs. Elizabeth Lewis Jackson ~~and husband~~. She is a sister ot Grandpa lewis.

We also visit Eli Lewis a cousin of my fathers and the son of james Lewis. He told us hhat james lewis was buried in Wallis cementary just East of Des Arc.

~~James~~ He had lived between 1846 and 1918.

MA January 24 1973

Leta Bahn and Billie J. Lewis went to Ironton mo the the court house to check on the lewis family. We found the in the e arly real Estate Tzansfers the there came up the names of David Lewis and John Lewis who we thought might be the Brothers of George Lewis who was our great grand fathers. We also found the wedding dates of some of our great annts and Uncles which are found listed elsewhere. SSSSSSSSSSSSSS

We found that Great grand Pa Lewis bought the farm outside of Annapolis in Dec 1857 and died some time before Jan 18 1858. The farm was later bought by William Lewis from the heirs of George Lewis and was sold by William Lewis in 1884. to a John Benson. William Lewis Sr. and Uncle Robert Lewis bought the home of Billie J. Lewis the farm from Des Arc from P M Maddock on 19 Feb 1890. Robert Lewis and wife sold their interest the Abigail Lewis on 11 Apr 1892. she in turn sold the farm to J B Lewis and Fred Lewis 9 Sept 1913.

We also check the Probate court file 394 copies of which are in this file.

After leaving the court house we talked to cousin Clarence Keathley 318 eidson who showed us a Book of another lewis family of the St. Clair Mo. area History of the Lewis Family 1635 to 1958. in this book there was a papagraph reading in part as followan

George lewis and family, David lewis and family left Tennessee for missouri Following the death of thier father Nathan lewis in South Carolina<sup>99</sup> (the dates of 1808 and 1809 appear in this paragraph but no reason why) It says they spent a night with Uncle John Crocket Father of David Crockett and then proceeded to missouri. a son of john crockets went with them for one days journey. ~~XXXXXXXXXXXXXXXXXXXXXXXXXXXXXXXXXXXX~~

Clarence is to check with the Stl Clair lewis and also the old iron county newspapers on further info on george lewis.

next trip to Madison county to check old land records and also to jackson.

Land Holdings of George Lewis at Death in 1858

Deed from David Morrow to the North west 1/4 of South east 1/4 and East 1/2 and south west 1/4 of south west 1/4 and south west 1/4 of North west 1/4 of Section 15 Township 31 North east containing 200 Acres.

Government Deed for south west 1/4 of South East 1/4 Section 28 and South east 1/4 of south west 1/4 Section 34 Township 32 N R 3 east containing 80 Acres.

~~Also the south west 1/4 of South west 1/4 Section 27~~ the n North west 1/4 of North east 1/4 section 33 and the north west 1/4 of north west 1/4 section 34 township 32 N R 3 East containing 120 acres.

The east 1/2 lot no 2 North east 1/4 section 3 township 31 N. R 3 East containing 56 30/100 acres

and the South west 1/4 of South east 1/4 Section 34 township 32 N R 3 east containing 40 acres

and the South east 1/4 of South east Section 28 township 32 N R and E Containgh 40 Acres.

Deed from John Lewis and wife to a part of Southeast 1/4 of South east 1/4 section 34 township 32 N R and East Containing 33 Acres.

Deed from David Lewis and wife to a part of North east 1/4 of South east 1/4 and North west 1/4 of ~~XXXXXXX~~ of South east 1/4 Section 34 township 32 N R 3 East Containing 35 acres.

Section. 27

The south west 1/4 of south west 1/4 section 27

Section 28

Sout h west 1/4 of South east 1/4 Section 28

7 The south east 1/4 ~~of south~~ of south east 1/4 section 28

Section 34 *Twen. 32*

1 " South east 1/4 of south west 1/4 section 34

*Range 32 3 E*  
*1323 E*

~~2 North west 1/4 of north west 1/4 section 34~~

3 South west 1/4 of south esat 1/4 section 34

4 south east 1/4 of south east 1/4 section 34

5 North east 1/4 of south east 1/4 and north west 1/4  
of south east 1/4 section 34

Section 33

North west 1/4 of north east 1/4 section 33

# SECTION 35

township 31

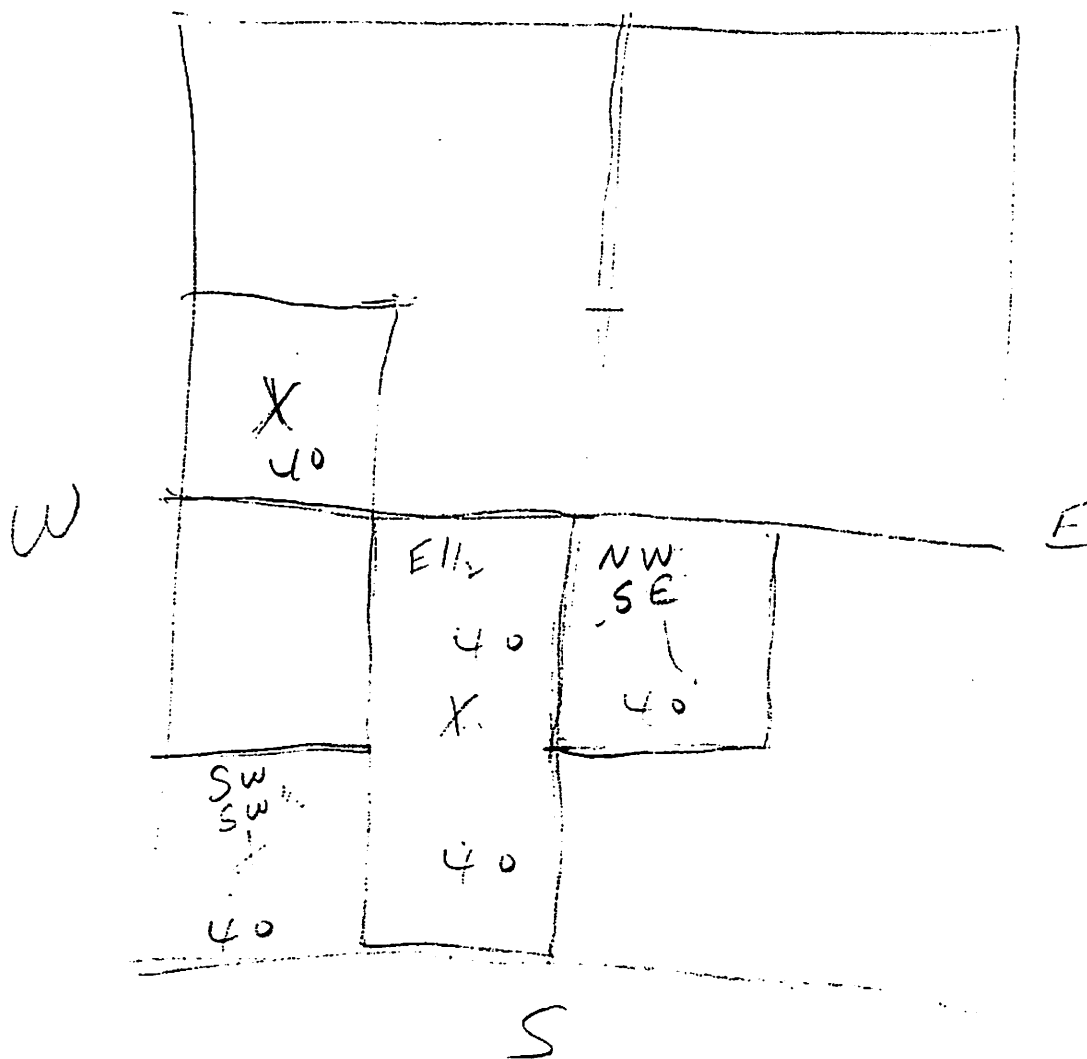

28

27

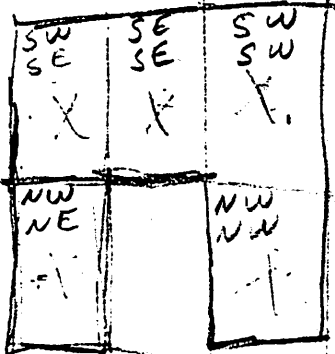

200

33

NW  
SE  
X

NE  
SE

34

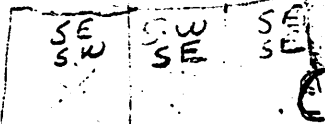

200

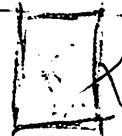

sect 3  
township 31

Mary & Jane Hale State of Tenn  
Griffith in Arkansas

date 18 Jan 1858

Lepsi Lendunio <sup>July 1/2</sup> 1867

Clarence Keather

318 Edison

Montommo 63650

ph 546-3714

May & June Hall Stoughton  
Guffin & Alanson

date 18 Jan 1858

Lepsi Lundgren <sup>July 1/2</sup> 1867

Clarence Keather

318 Edison

Montommo 63650

ph 546-3714



Our Fair

Book 37 - pge 105

P.M. Maddock to Wm SR & Robert L Lewis  
Uncle Bob

19 Feb 1890

---

Book 37 pge 380  
11 Apr 1892

Robert L. & wife Emma to Abigail Lewis

---

- Book 48 pge 379

9 Sept 1913

Abigail to J.B. Lewis & Fred Lewis

February 18, 1973

Page 1.

Leta bahn and I went to annopolis agiain checking on relatives.

We visited the wallis cemenetqry at Des ARc mo, the Lewis Cementary south of annopolis. At annopois is Buried Drew ~~SSSS~~ Lewis ~~XXXX~~ son of Great uncle andy lewis and Samuel Jackson son of Elāzabeth lewis Jackson. Then we visited with Macy Slusher who told us her husbands Mother was Minerva Hale son of Mary Lewis Hale. Minerva Hale came to Missouri from tennessee about 1872.

We Then talked to a John Bollinger who lived up on Carver creek he sent us to a Cementary at the old Emiline Chapel where be found buried Uncle (GU) Robert and a son of GU J<sup>hn</sup> Lewis ~~ZZZZZZZZZZ~~ and also GU John is believed to be buried there but there is no marker. Also other lewis's are buried there.

After this we talked to a Frank Zelany who live on part of GG George farm.

After this we talked to Issom Lewis who is a grand son of GU Benjamin Lewis His father is William (PUMkōn William)Lewis. He told us that Benjamin and wife Oma lewis died when william was a very young boy.

We then talked to Maude Sutton grand daughter of Hepsi lewis ruble. we found out hhat a lot of Pumkin William~~ll~~ Lewis Descendants married lotsk of Rubles.

Wm Lewis  
Ramble PB

February 18, 1973 Cont.

Page 2

After this we called Nettie Goodman, Anna Mae Webb,  
and <sup>JOHN</sup> ~~A~~ Castael, who are Grand children of Martha Lewis  
Casteel (Castile) In reading a obituary of Martha Lewis  
Casteel we found that here parents were George and  
Elizabeth Lewis and they came to Missouri from tennessee  
some time around 1849. and settled on Carver creek which  
is north west of Sabula, Mo. In the general area of  
the  
The Emiline Cahpel where Robert lewis is buried.

End

August 30, 1973

Leta Bahn and I went to Iron County to once again check on the lewis history.

Most of the morning was spent in the court house checking the land records and the Probate files. the only additional probate file found was that of Benjamin Lewis son of George lewis.

After Lunch we visited with Everett Lewis, 305 N. Shephard. He is a retired Nazarine Minister a grand son of my great Uncle Robert Lewis. He had a lot of knowledge about great Uncle Robert and decendents but gave us no additional help about George Lewis. He also had a wonderful collection of pictures of his lewis family. He also mentioned he was told that his grandfather and ours were only Half Brothers.

Next we visited Mabel reese who lived on Mo untian street

From the reeses we went ot Visit Clara West who is a descendent of Great Uncle Andrew Lewis. she told us that she remembered when Andrew died. Also he was recieving a pension from the Cival War, or the spanish american war. Also he was 69 years old when he died. He is buried in the lewis cemenatary south of annapolis but there is no Stone.

From there we went to ~~XXXXXX~~ Annapolis and talked to Jesselyn Lewis who promised to try to see the Abstract of John Bollingerto find out when "George" Came to Missouri.

After this we walked to Anna Marie Webb a descendent of Martha Casteel. She didn't have any information of any help.

Next we stopped by to say Hello toMacy Slusher. and gave her some of the Histories of the lewis Family to give out at the Lewis Ruble ReUnion at Vulcan.

On the way home we dicieed to get the death certificates of some of our older Uncles.